

# SIGNATURE

## NORTH EAST

OFFICIALLY RATED THE NO.1 ESTATE AGENT IN THE NORTH EAST







📍 Grey Street, North Shields NE30 2DZ



# Grey Street, North Shields NE30 2DZ

**Offers Over £114,000**

Signature North East are delighted to welcome to the sales market this stunning, two-bedroom first floor flat situated on Grey Street, North Shields, which is offered with no upper chain.

This property boasts modern decor, a recently fitted kitchen and bathroom, spacious rooms throughout and is near an abundance of amenities such as shops, supermarkets, Northumberland park, public transport links and is only a short distance to the vibrant North Shields Fish Quay which is home to a variety of restaurants and bars.

Upon entry to the property, you are welcomed in to the spacious hallway which gives access to the principal rooms. First is the living room, boasting ample space for furnishings and showcases lovely features like original cornicing, neutral decor and a large window which allows natural light to flood the room. Next is the ultra-modern kitchen with recently fitted Navy wall and base units finished with marble effect countertops and gold fixtures. There are also some integrated appliances such as fridge, freezer, oven, induction hob and an anthracite sink.

The master bedroom displayed ample space for a double bed and other desired furnishings, as well as neutral decor. The second smaller bedroom offers versatility to be used as a home office/study, dressing room or single bedroom if desired. Finishing this home is the newly refurbished three-piece bathroom, fitted with a bath and overhead shower, w.c and sink with grey vanity unit.

Externally to the rear is a large, shared yard. To the front of the home there is on-street parking available.

Tenure: Tyneside lease  
Council tax band: A

PLEASE NOTE THAT THE VENDOR HAS CERTIFIED THE PROPERTY INFORMATION AND IMAGES.



# PROPERTY FLOORPLAN

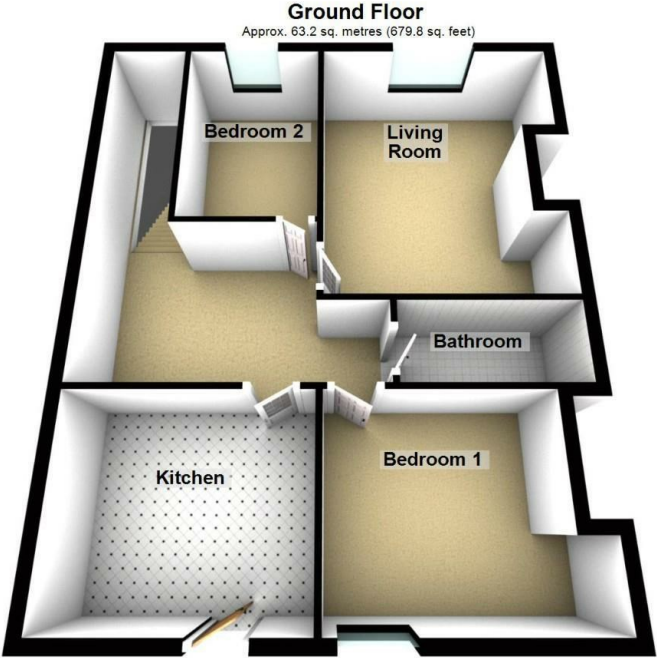

## Measurements:

Living room  
12'6" x 15'1"

Kitchen  
11'11" x 7'1"

Bedroom 1  
12'4" x 10'2"

Bedroom 2  
7'3" x 10'9"

Bathroom  
8'11" x 4'1"

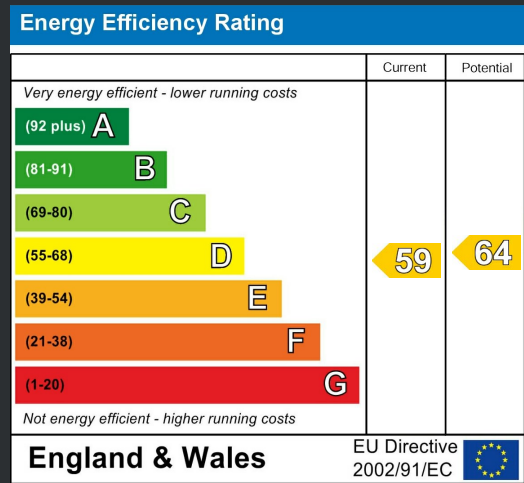







More 5 Star Customer Reviews than any other Agent based in the North East on [allAgents.co.uk](https://allagents.co.uk)



**SALES**

**LETTINGS**

**FINANCE**

**LAW**

**WE COVER THE WHOLE OF THE NORTH EAST**

Whitley Bay  
0191 251 3344

Cramlington  
01670 897 213

Tynemouth  
0191 296 6689

Morpeth  
01670 513 966

Ponteland  
01661 820 082

Wallsend  
0191 432 4151

Alnwick  
01665 511 800

Heaton  
0191 432 4275

Forest Hall  
0191 266 9966

Other locations  
0191 640 3523

Newcastle  
0191 640 2284

Durham  
0191 303 8252

Gosforth  
0191 640 3523

Sunderland  
0191 543 6390

Whickham  
0191 432 5102

Gateshead  
0191 432 4294

Jesmond  
0191 281 1037

Killingworth  
0191 640 3602

Ryton  
0191 413 9845

Head Office &  
Lettings  
0191 253 4815

\*Highest recommended 5-star reviews than any other Estate Agent based in the North East on [allAgents.co.uk](https://allagents.co.uk) - The UK's Largest Customer Review Website for the Property Industry & Awarded Best Estate Agency 2018 & 2019 - North East England by SME News